

# CONEXPO CON/AGG - 03/14/23 - 03/18/23

LAS VEGAS CONVENTION CENTER - NORTH MEETING ROOMS - LAS VEGAS, NV

## LOWER LEVEL NORTH MEETING ROOMS

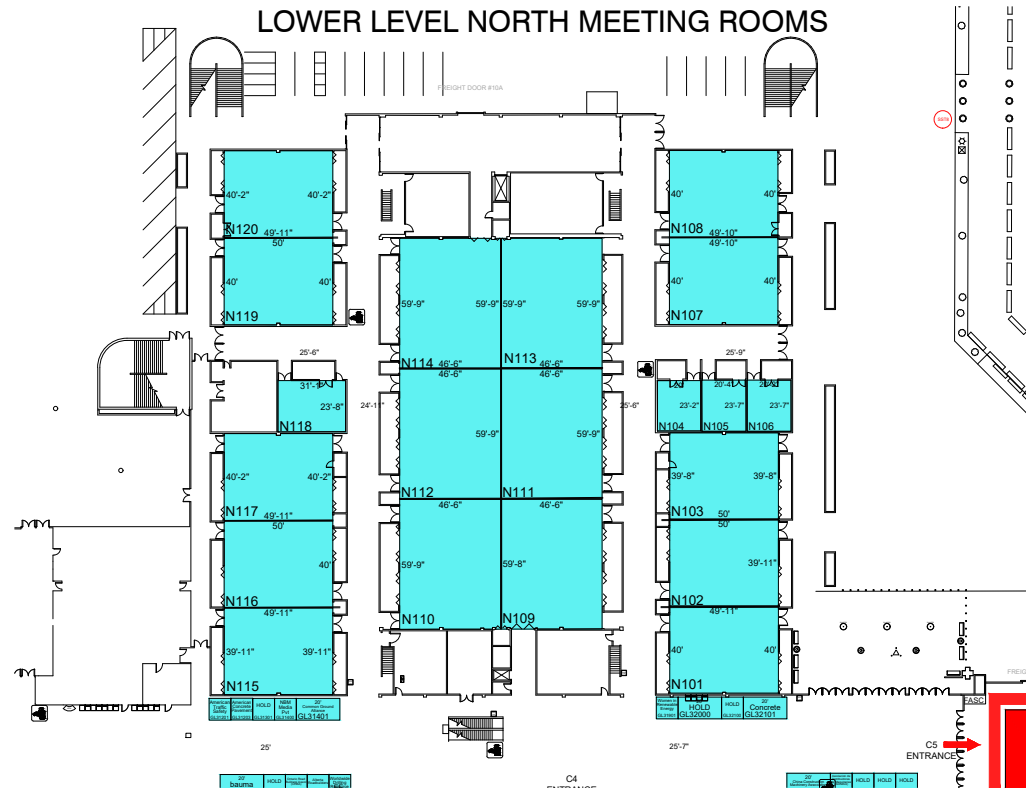

## UPPER LEVEL NORTH MEETING ROOMS

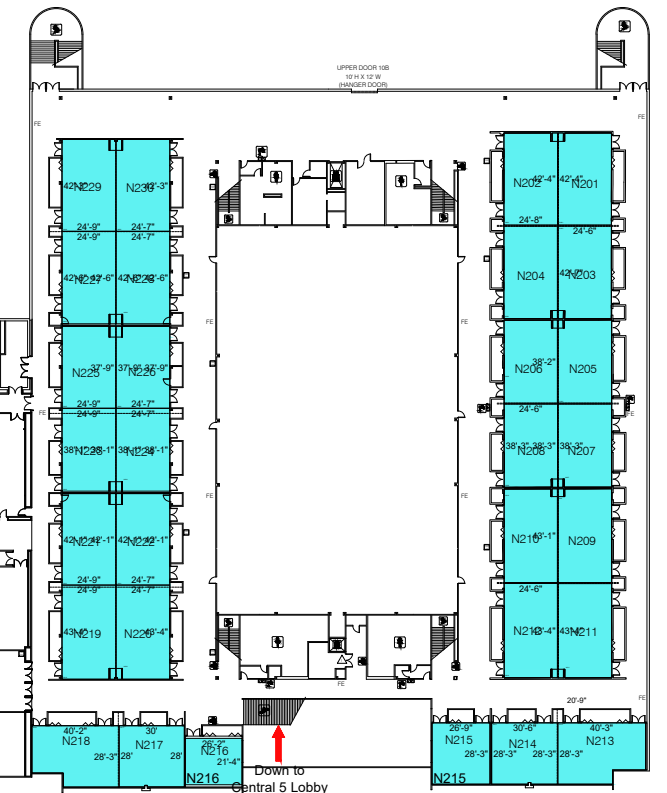

**NORTH MEETING ROOMS MOVE OUT TARGET**  
 Monday March 20, 2023 \* 12:00:00PM

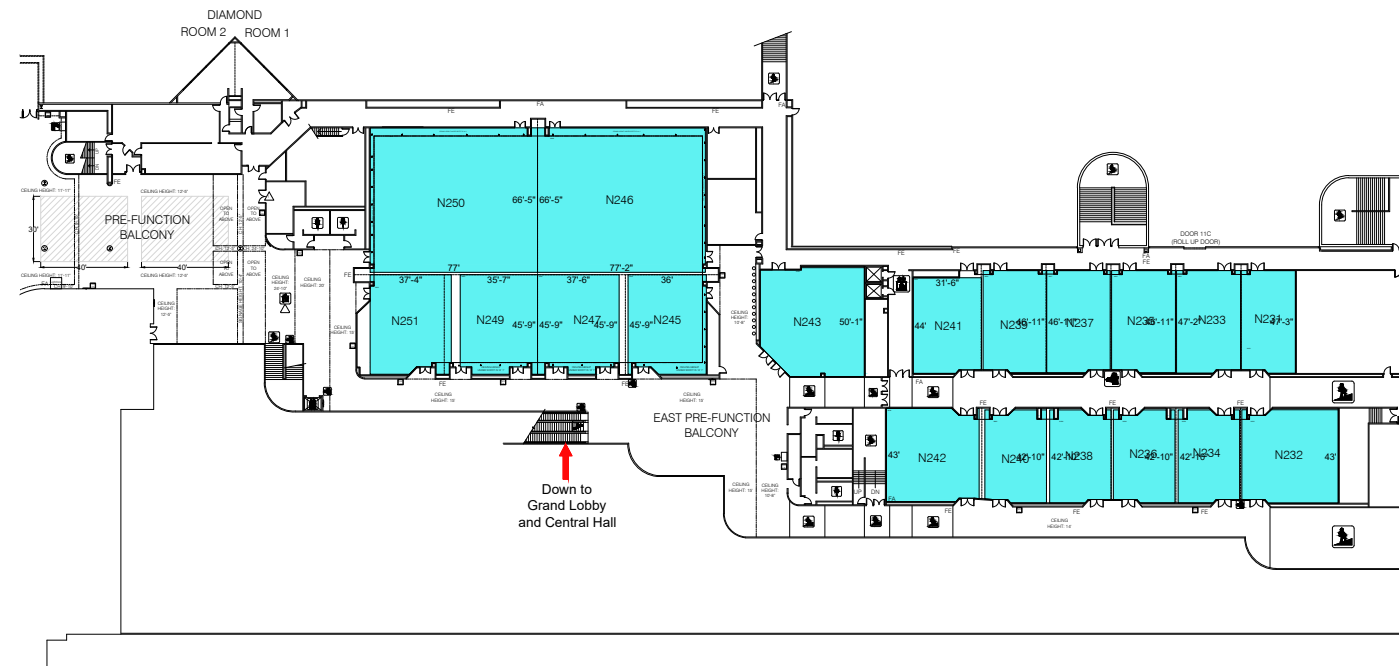

- Reminder about TARGET DATES AND TIMES:
  - These are for your trucks to check in at the marshalling yard. It will take time to unload your shipments, so please order labor for the following day.
  - Please have a representative in your booth during your target date to confirm placement of your 'one time spot' that is included in your freight package.
- Please contact your dedicated FREEMAN COMMAND CENTER for any questions you may have  
[conexpoconaggsupport@freeman.com](mailto:conexpoconaggsupport@freeman.com)  
[ifpesupport@freeman.com](mailto:ifpesupport@freeman.com)  
 Phone: 855-473-0476
- Submit your Freight Machinery & Equipment Questionnaire by clicking here:  
<https://www.freemanco.com/store/freight-form?showID=507357&formType=FreightMachinery>
- Click here for Target change requests  
<https://www.freemanco.com/store/show/target-change-request?showID=507357>
- Submit your Heavy Equipment Cleaning Request form  
<https://www.freemanco.com/store/freight-form?showID=507357&formType=heavyEquipmentCleaning>
- Submit your Equipment Painting Request form  
<https://www.freemanco.com/store/freight-form?showID=507357&formType=equipmentPainting>



**Disclaimer** - This floor plan is preliminary and subject to change pending review and official approval by all authorities having jurisdiction. Every effort has been made to ensure the accuracy of all information contained on this floor plan. However, no warranties, either expressed or implied, are made with respect to this floor plan. If the location of building columns, utilities or other architectural components of the facility is a consideration in the construction or usage of an exhibit, it is the sole responsibility of the exhibitor to physically inspect the facility to verify all dimension and locations. © Copyright 2022, Freeman, all rights reserved. **Confidential and Proprietary** - the information contained herein is the proprietary information of Freeman and by accessing the information, the recipient agrees to keep the information confidential and not disclose it to any third party without the prior consent of Freeman. Recipient also agrees to only use the information for its internal evaluation purposes and for no other purpose, without the prior consent of Freeman.

Drawing Started:  
10/4/2022  
Started By:  
GISELA

Acct. Sales:  
BRENT LINKIN  
Account Mgmt.:  
DANIEL BAUMGART

Revision Date:  
10/5/2022  
Revised By:  
GISELA

Line Item:  
**7846811**  
Scale:  
CUSTOM